

# 18. NUNGAMBAKKAM

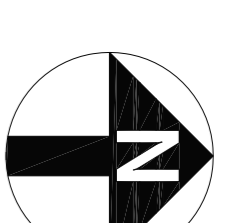

(Village Name - Nungambakkam)

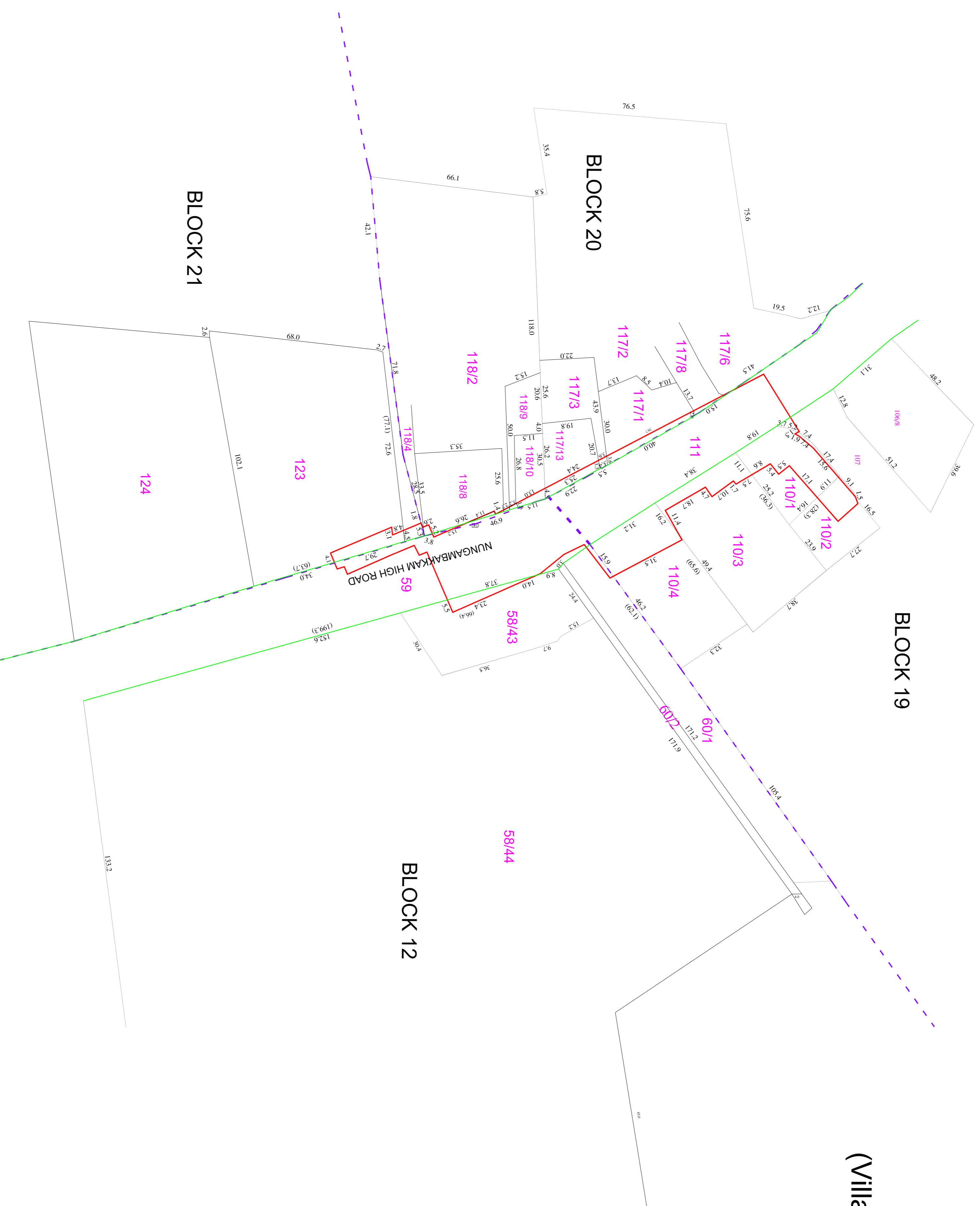

**LEGEND**

PROPOSED CMRL STATION BOUNDARY	—
BLOCK BOUNDARY	—
FIELD BOUNDARY	—
ROAD BOUNDARY	—

CLIENT :		CHENNAI METRO RAIL LIMITED	
SURVEY CONSULTANT :		Prime Meridian Surveys Private Limited.,	
GENERAL NOTES :		1. ALL DIMENSIONS ARE IN METER UNLESS OTHERWISE NOTED	
REV.	DATE	DESCRIPTION	
DESIGNED/DRAWN:		G.SIVA	
TITLE :		CHENNAI METRO RAIL PROJECT PHASE - II	
DRAWING NUMBER:		PMSPL/CMRL/PII/COR 3/STN/ILPS/18	
SHEET NO.		A1	
SCALE:		1:1000	
DRAWN DATE:		29-08-2018	

Adm Building, CMRL Depot,  
Koyambedu, Chennai - 600 107.  
Ptc. 044-23792200, Fax: 044-23792200.  
Email: chennaimetrorail@gmail.com

New No. 68/6 (Old No. 63/6),  
Madhavji Apartment, Jones Road,  
Saidapet, Chennai - 600 015.  
Ptc. 044-23813688, Fax: 044-23813689.  
Email: meridian-surveys@gmail.com

