

02.THAPAL PETTI

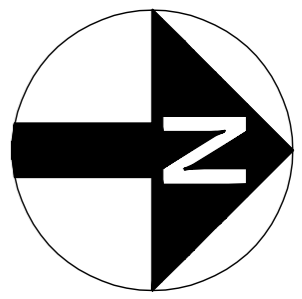

MADHAVARAM

SIRUSERI

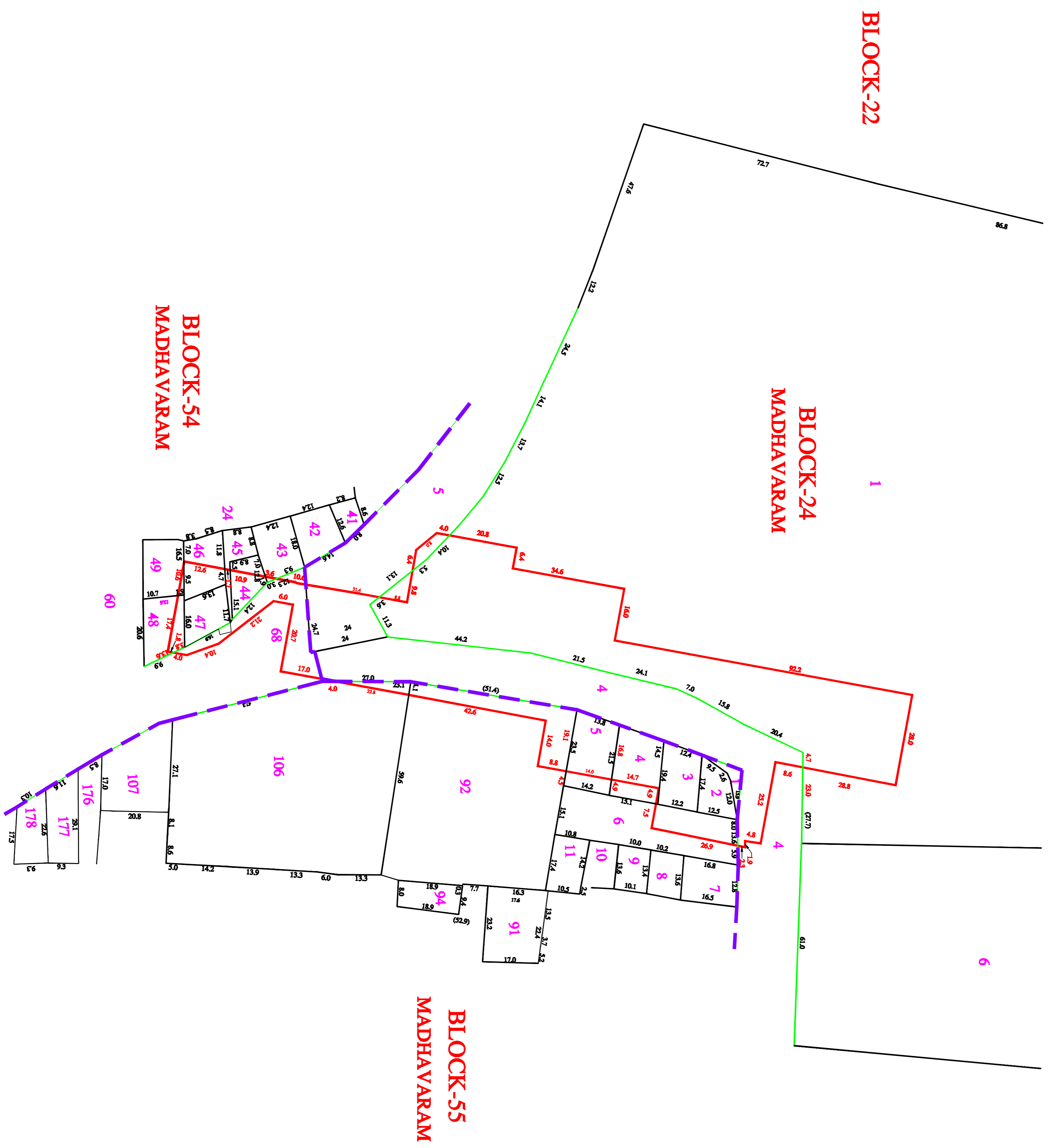

**LEGEND**

- PROPOSED CMRL STATION BOUNDARY
- BLOCK BOUNDRY
- FIELD BOUNDRY
- ROAD AND BOUNDRY

**Thiruvallur METRO RAIL LIMITED**  
 Admin Building, CMRL Depot,  
 Poornimala High Road,  
 Koyambedu, Thiruvallur - 600 107,  
 Pn: 044-23792000, Fax: 044-23792200,  
 Email: Thiruvallurmetro@gmail.com

**Prime Meridian Surveys Private Limited,**  
 New No. 88/6 (Old No. 63/6),  
 Madhavangal Apartment, Jones Road,  
 Saldalai, Thiruvallur - 600 015,  
 Pn: 044-23813888, Fax: 044-23813888,  
 Email: meridiansurveys@gmail.com

**GENERAL NOTES:**  
 1. ALL DIMENSIONS ARE IN METERS (UNLESS OTHERWISE NOTED)

REV.	DATE	DESCRIPTION

CGM (UG) - CMRL

DESIGNED BY: \_\_\_\_\_  
 CHECKED: G.SIVA

<b>Thiruvallur METRO RAIL PROJECT PHASE - II</b>	
TITLE:	THAPAL PETTI
DRAWING NAME:	LAND PLAN SCHEDULE
DRAWING NUMBER:	PMS/PL/CMRL/PI/CCOR/3/STN/PLPS/2
SHEET NO:	1 of 1
SHEET SIZE:	A1
SCALE:	1:1000
DRAWN DATE:	19-06-2018