

SIRUSERI

28.INDIRA NAGAR

MADHAVARAM

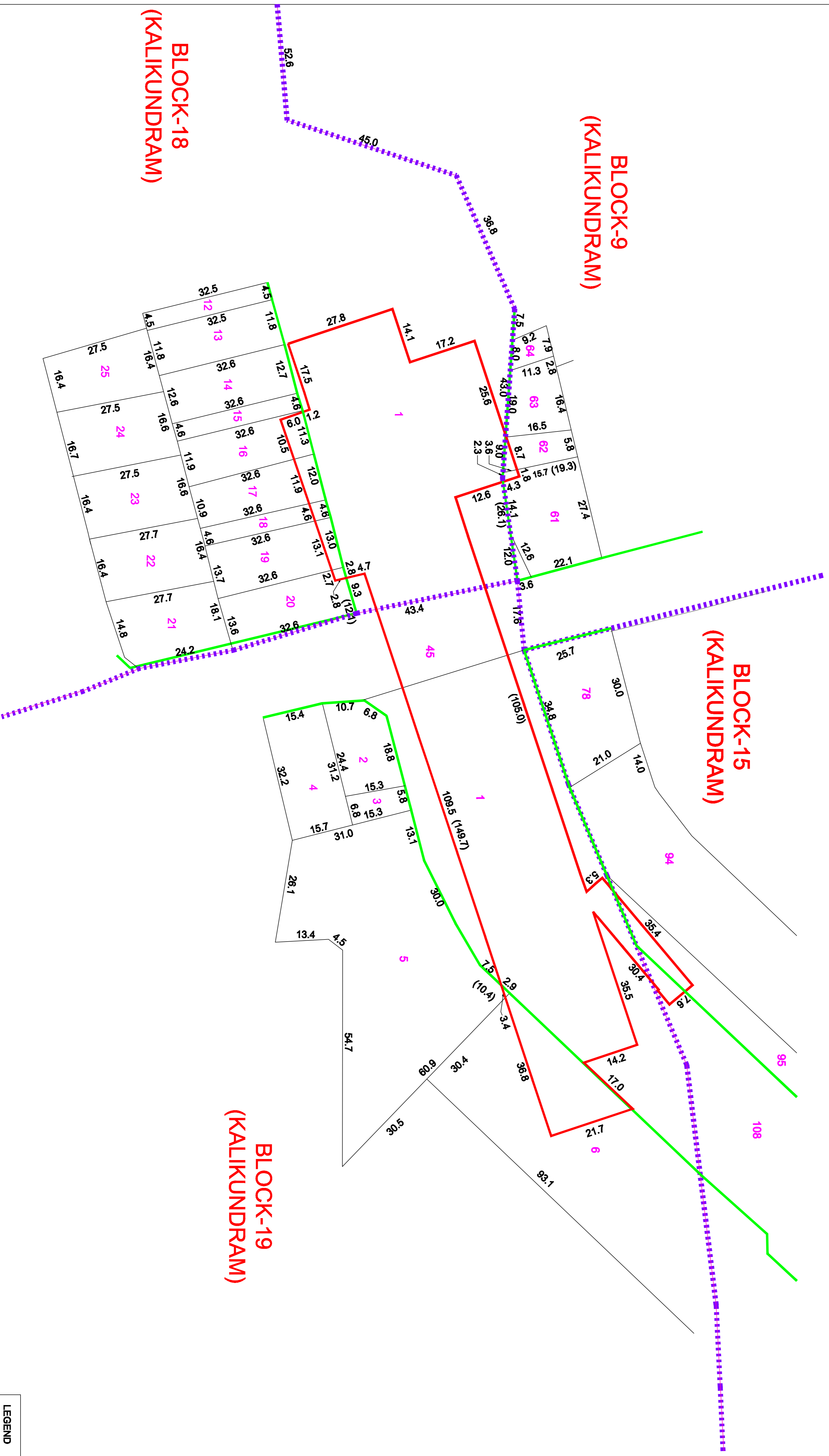
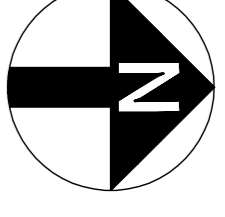

**BLOCK-18**  
**(KALIKUNDRAM)**

**BLOCK-9**  
**(KALIKUNDRAM)**

**BLOCK-15**  
**(KALIKUNDRAM)**

**BLOCK-19**  
**(KALIKUNDRAM)**

**LEGEND**

—	PROPOSED CHRL STATION BOUNDARY
—	BLOCK BOUNDARY
—	FIELD BOUNDARY
—	ROAD BOUNDARY

CLIENT: <b>CHENNAI METRO RAIL LIMITED</b>  Admin Building, ChRL Dept, Poonamallee Chenna Road, Koyambakkam Chennai - 600 107 P. No: 44-23132800   Fax: 044-23132200 Email: chennaimetro@chennaimetro.com	SURVEY CONSULTANT: <b>Prime Meridian Surveys Private Limited,</b>  New No. 69B (Old No. 69B), Madhavaram Apartment, James Road, Suburban Chennai - 600 015 P. No: 44-23132898   Fax: 044-23132898 Email: info@prime-m.com	GENERAL NOTES: 1. ALL DIMENSIONS ARE IN METERS UNLESS OTHERWISE NOTED.	REV.	DATE	DESCRIPTION	CGM (UG) - CHRL	DESIGNED BY: G.SVB	CHECKED:	DRAWING NUMBER: PMSP/CMRL/P11/COR 3/STN/LP/2/8	DRAWN DATE: 28-08-2018
			TITLE: INDIRA NAGAR							
<b>CHENNAI METRO RAIL PROJECT PHASE - II</b>		DRAWING NAME: LAND PLAN SCHEDULE		SCALE: 1:500		SHEET NO: 1 of 1		SHEET SIZE: A1		DRAWN DATE: 28-08-2018