

STATION NO.03.ASSISI NAGAR

MADHAVARAM

SHOLINGANALLUR

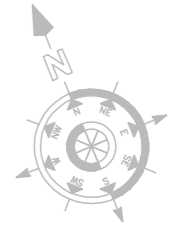
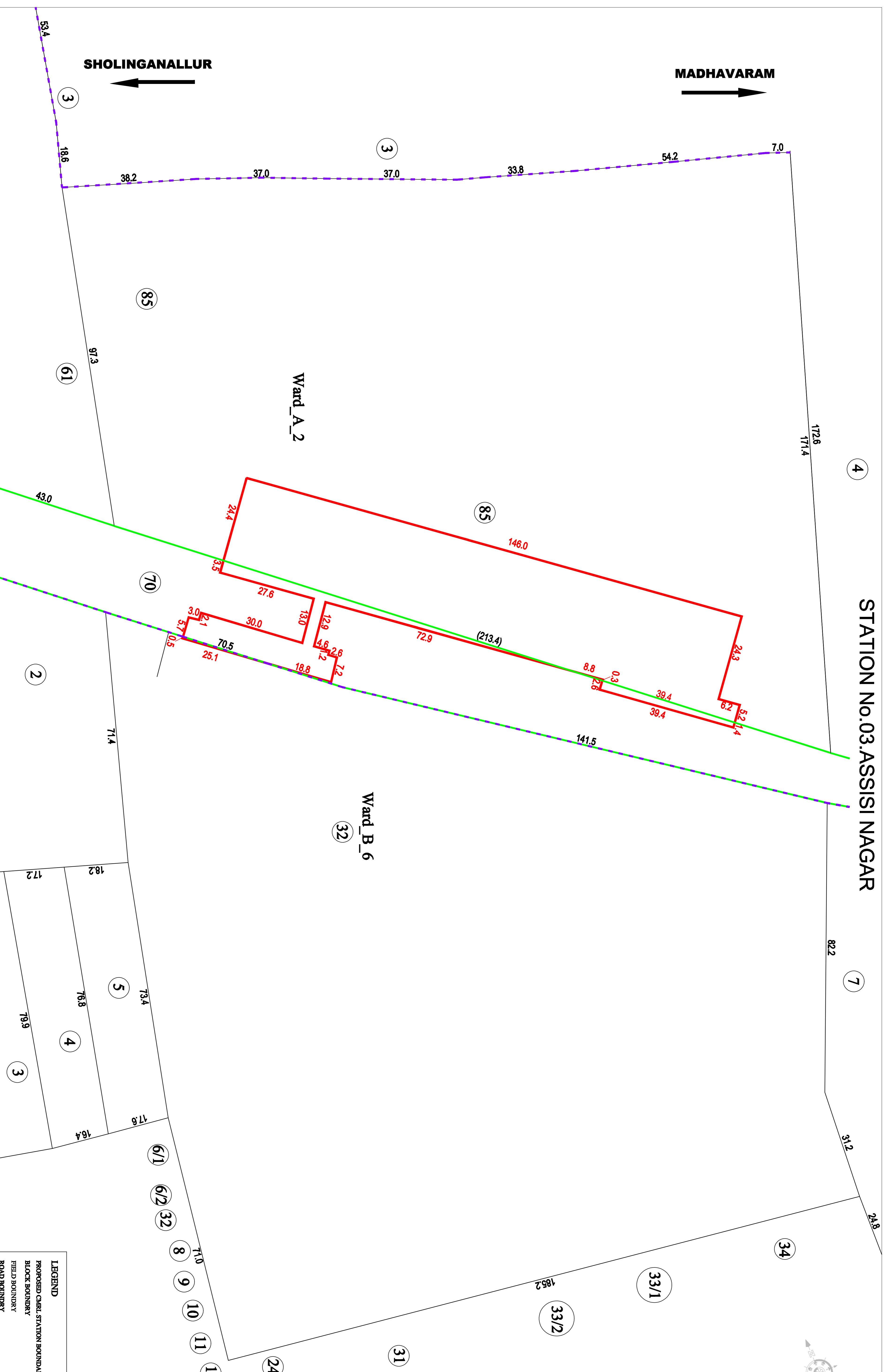

CHENNAI METRO RAIL LIMITED
 Adm Building, CMRL Dept.,
 Poonamallee High Road,
 Koyambedu, Chennai - 600 107.
 Ph: 044-23192000, Fax: 044-23192200.
 Email: chennaiMetroRail@gmail.com

PRIME MERIDIAN SURVEYS PRIVATE LIMITED,
 SURVEY CONSULTANT:
 New No. 89/6, (Old No. 53/6),
 Madhavangal Apartment, Jones Road,
 Saidapet, Chennai - 600 015.
 Ph: 044-23813888, Fax: 044-23813889.
 Email: meridianSurveys@gmail.com

GENERAL NOTES:
 1. ALL DIMENSIONS ARE IN METERS UNLESS OTHERWISE NOTED.

REV.	DATE	DESCRIPTION

CGM (U/G) - CMRL

G. Sivagnanam

CHENNAI METRO RAIL PROJECT PHASE - II
 TITLE : ASSISI NAGAR
 DRAWING NAME : LAND PLAN SCHEDULE
 DRAWING NUMBER : PMSPL/CMRL PI/COR 5/STN/LPS/03
 SHEET NO : 1 of 1
 SHEET SIZE : A1
 SCALE : 1 : 500
 DRAWN DATE : 28.06.2018

LEGEND

PROPOSED CMRL STATION BOUNDARY	— (Red dashed line)
BLOCK BOUNDARY	— (Blue dashed line)
FIELD BOUNDARY	— (Green dashed line)
ROAD BOUNDARY	— (Black solid line)