

32.KANDHANCHAVADI

MADHAVARAM
→

←
SHOLINGANALLUR

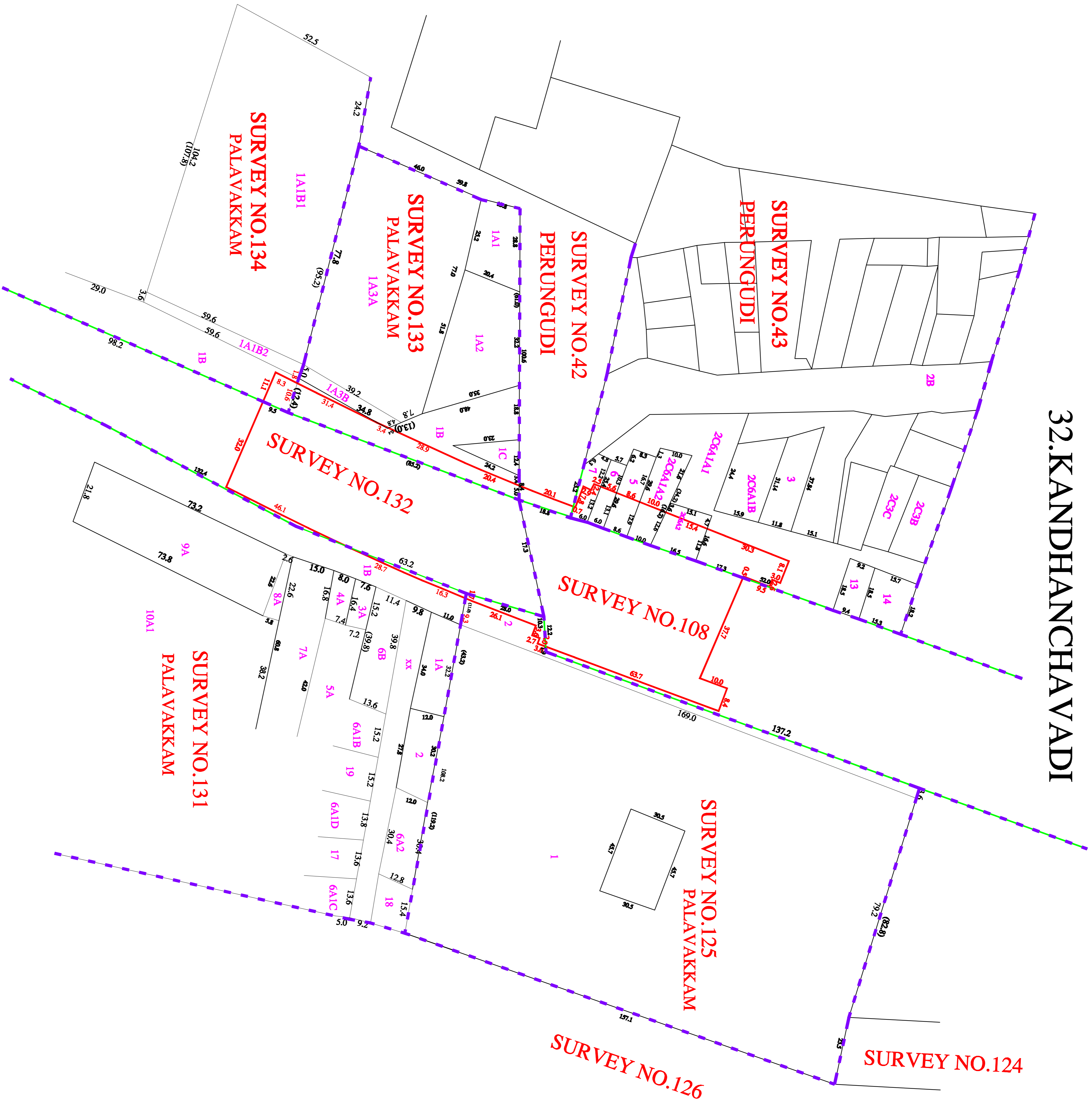

LEGEND

- PROPOSED CMRL STATION BOUNDARY
- BLOCK BOUNDARY
- FIELD BOUNDARY
- ROAD BOUNDARY

CHENNAI METRO RAIL LIMITED
Admin Building, CMRL Depot,
Poonamallee High Road,
Koyambedu, Chennai - 600 107.
Prt: 044-23792000, Fax: 044-23792200.
Email: chennai@metro-rail.com

PRIME CONSULTANT:
Prime Meridian Surveys Private Limited,
New No. 88/6, (Old No. 63/6),
Maddur Apartment, Jones Road,
Saidapet, Chennai - 600 015.
Prt: 044-2813888, Fax: 044-2813888.
Email: meridian@primeconsultant.com

1. ALL DIMENSIONS ARE IN METERS, UNLESS OTHERWISE NOTED.

This drawing is the property of Chennai Metro Rail Limited and shall remain the property of Chennai Metro Rail Limited. It shall not be used for any other purpose without the prior written permission of Chennai Metro Rail Limited.

| REV. | DATE | DESCRIPTION |
|------|------|-------------|
| | | |
| | | |

CGM (UG) - CMRL

| | |
|--|-----------------------------------|
| DESIGNED BY: | R.K |
| CHECKED: | G.SIVA |
| CHENNAI METRO RAIL PROJECT PHASE - II | |
| TITLE: | 32.KANDHANCHAVADI |
| DRAWING NAME: | LAND PLAN SCHEDULE |
| DRAWING NUMBER: | PMS/PL/CMRL/PI/COOR/31ST/IL/PS/32 |
| SHEET NO: | 1 of 1 |
| SHEET SIZE: | A1 |
| SCALE: | 1:1000 |
| DRAWN DATE: | 27-01-2018 |