

# 43.SATHYABAMA UNIVERSITY

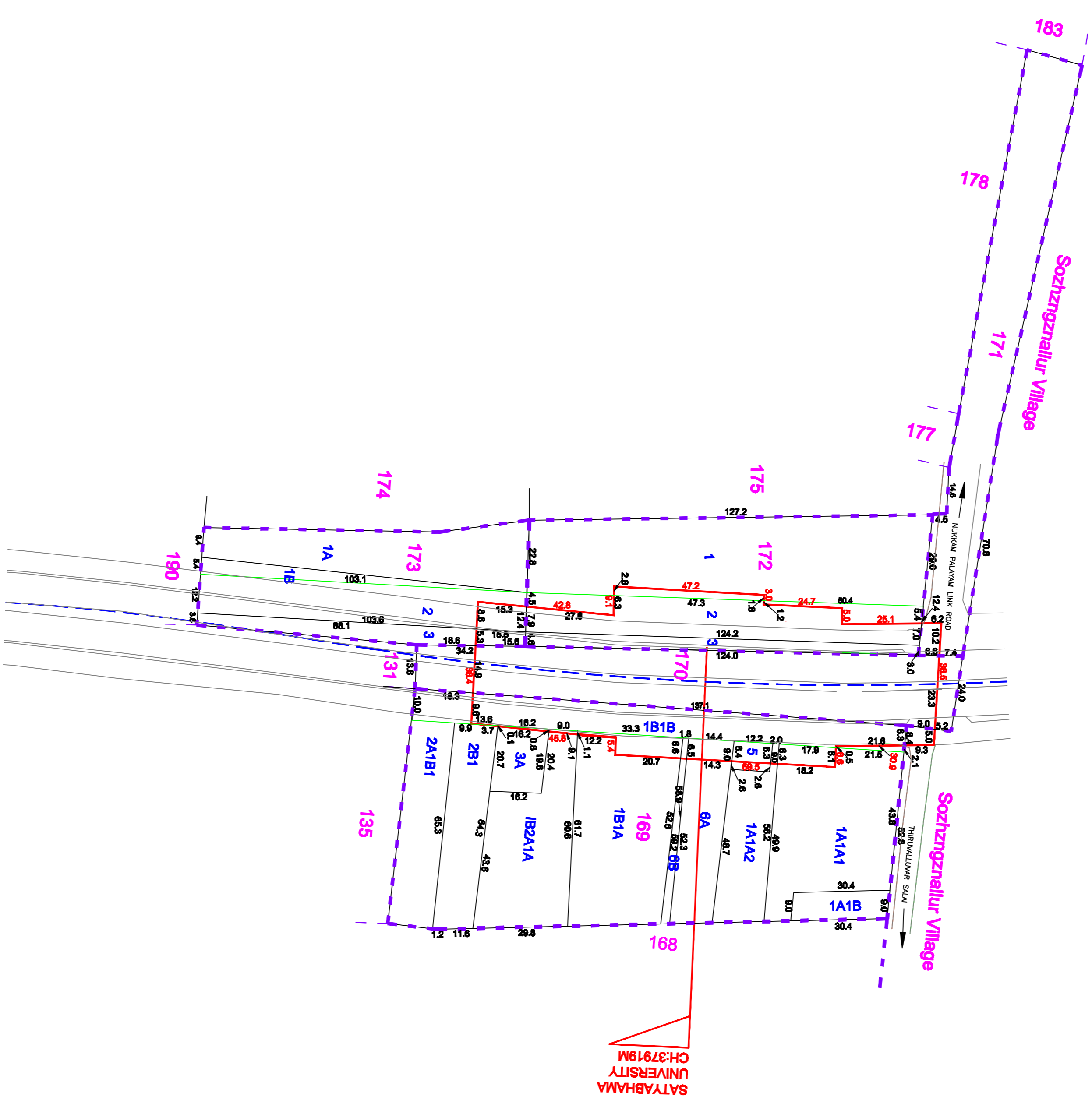

**LEGEND**

PROPOSED CMRL STATION BOUNDARY	—
BLOCK BOUNDARY	—
FIELD BOUNDARY	—
ROAD AND STREET BOUNDARY	—

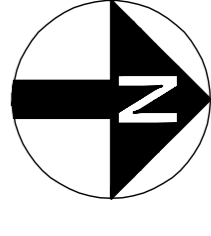

<b>CLIENT:</b> <b>CHENNAI METRO RAIL LIMITED</b> Admin Building, CMRL Depot, Poovunthee High Road, Koyambedu, Chennai - 600 107. Ph: 044-23782000, Fax: 044-23782200 Email: chennai@metro.rail.in	
<b>SURVEY CONSULTANT:</b> <b>Prime Meridian Surveys Private Limited,</b> New No. 69/6 (Old No. 53/6), Medinagar Apartment, Jones Road, Saidapet, Chennai - 600 015. Ph: 044-23819888, Fax: 044-23819889. Email: meridian@prime.com	
<b>GENERAL NOTES:</b> 1. ALL DIMENSIONS ARE IN METERS UNLESS OTHERWISE NOTED.	
<b>DESIGNED/DRAWN:</b> G.SIVA	<b>CORR (U/G) - CMRL</b>
<b>TITLE:</b> 43.SATHYABAMA UNIVERSITY	<b>SHEET NO</b> 1 of 1
<b>DRAWING NAME:</b> LAND PLAN SCHEDULE	<b>SHEET SIZE</b> A1
<b>DRAWING NUMBER:</b> PMSPL/CMRL PII/COR 3/STN/PLS/43	<b>SCALE:</b> 1:100
<b>DATE:</b> 30-07-2019	<b>DRAWING DATE:</b> 30-07-2019